

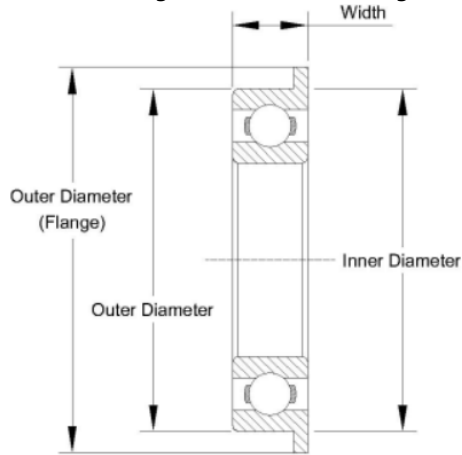

MF Series Flanged Miniature Bearings



Part Number	Bore diameter	Outside diameter	Width	Flange outer diameter	Flange thickness	Seal type	Ring material	Ball material	Limiting speed
MF41x	1.2 mm	4 mm	1.8 mm	4.8 mm	0.4 mm	Open	Chrome Steel	Chrome Steel	110 X 1000 rpm
MF52	2 mm	5 mm	2 mm	6.2 mm	0.6 mm	Open	Chrome Steel	Chrome Steel	85 X 1000 rpm
MF52 2rs	2 mm	5 mm	2.5 mm	6.2 mm	0.6 mm	Sealed	Chrome Steel	Chrome Steel	85 X 1000 rpm
MF52zz	2 mm	5 mm	2.5 mm	6.2 mm	0.6 mm	Shielded	Chrome Steel	Chrome Steel	85 X 1000 rpm
MF62	2 mm	6 mm	2.5 mm	7.2 mm	0.6 mm	Open	Chrome Steel	Chrome Steel	75 X 1000 rpm
MF62 2rs	2 mm	6 mm	2.5 mm	7.2 mm	0.6 mm	Sealed	Chrome Steel	Chrome Steel	75 X 1000 rpm
MF62zz	2 mm	6 mm	2.5 mm	7.2 mm	0.6 mm	Shielded	Chrome Steel	Chrome Steel	75 X 1000 rpm
MF72	2 mm	7 mm	2.5 mm	8.2 mm	0.6 mm	Open	Chrome Steel	Chrome Steel	63 X 1000 rpm
MF72 2rs	2 mm	7 mm	3 mm	8.2 mm	0.6 mm	Sealed	Chrome Steel	Chrome Steel	63 X 1000 rpm
MF72zz	2 mm	7 mm	3 mm	8.2 mm	0.6 mm	Shielded	Chrome Steel	Chrome Steel	63 X 1000 rpm
MF82x	2.5 mm	8 mm	2.5 mm	9.2 mm	0.6 mm	Open	Chrome Steel	Chrome Steel	71 X 1000 rpm
MF82x 2rs	2.5 mm	8 mm	2.5 mm	9.2 mm	0.6 mm	Sealed	Chrome Steel	Chrome Steel	71 X 1000 rpm
MF82xzz	2.5 mm	8 mm	2.5 mm	9.2 mm	0.6 mm	Shielded	Chrome Steel	Chrome Steel	71 X 1000 rpm
MF63	3 mm	6 mm	2 mm	7.2 mm	0.6 mm	Open	Chrome Steel	Chrome Steel	71 X 1000 rpm
MF63 2rs	3 mm	6 mm	2.5 mm	7.2 mm	0.6 mm	Sealed	Chrome Steel	Chrome Steel	71 X 1000 rpm
MF63zz	3 mm	6 mm	2.5 mm	7.2 mm	0.6 mm	Shielded	Chrome Steel	Chrome Steel	71 X 1000 rpm
MF83	3 mm	8 mm	2.5 mm	9.2 mm	0.6 mm	Open	Chrome Steel	Chrome Steel	60 X 1000 rpm
MF83 2rs	3 mm	8 mm	3 mm	9.2 mm	0.6 mm	Sealed	Chrome Steel	Chrome Steel	60 X 1000 rpm
MF83zz	3 mm	8 mm	3 mm	9.2 mm	0.6 mm	Shielded	Chrome Steel	Chrome Steel	60 X 1000 rpm
MF93	3 mm	9 mm	2.5 mm	10.2 mm	0.6 mm	Open	Chrome Steel	Chrome Steel	56 X 1000 rpm
MF93 2rs	3 mm	9 mm	4 mm	10.6 mm	0.8 mm	Sealed	Chrome Steel	Chrome Steel	56 X 1000 rpm
MF93zz	3 mm	9 mm	4 mm	10.6 mm	0.8 mm	Shielded	Chrome Steel	Chrome Steel	56 X 1000 rpm
MF74	4 mm	7 mm	2 mm	8.2 mm	0.6 mm	Open	Chrome Steel	Chrome Steel	60 X 1000 rpm
MF74 2rs	4 mm	7 mm	2.5 mm	8.2 mm	0.6 mm	Sealed	Chrome Steel	Chrome Steel	60 X 1000 rpm
MF74zz	4 mm	7 mm	2.5 mm	8.2 mm	0.6 mm	Shielded	Chrome Steel	Chrome Steel	60 X 1000 rpm
MF84	4 mm	8 mm	2 mm	9.2 mm	0.6 mm	Open	Chrome Steel	Chrome Steel	56 X 1000 rpm
MF84 2rs	4 mm	8 mm	3 mm	9.2 mm	0.6 mm	Sealed	Chrome Steel	Chrome Steel	56 X 1000 rpm



MF Series Flanged Miniature Bearings

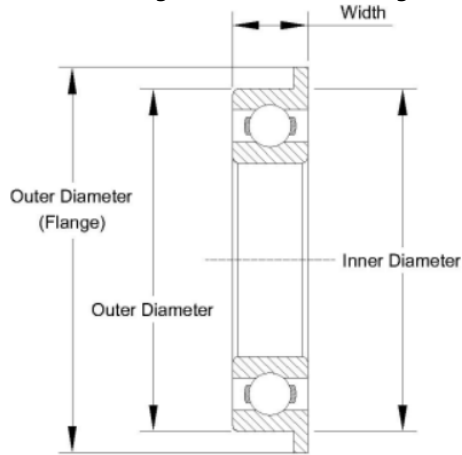

Part Number	Bore diameter	Outside diameter	Width	Flange outer diameter	Flange thickness	Seal type	Ring material	Ball material	Limiting speed
MF84zz	4 mm	8 mm	3 mm	9.2 mm	0.6 mm	Shielded	Chrome Steel	Chrome Steel	56 X 1000 rpm
MF104	4 mm	10 mm	3 mm	11.2 mm	0.6 mm	Open	Chrome Steel	Chrome Steel	48 X 1000 rpm
MF104 2rs	4 mm	10 mm	4 mm	11.6 mm	0.8 mm	Sealed	Chrome Steel	Chrome Steel	48 X 1000 rpm
MF104zz	4 mm	10 mm	4 mm	11.6 mm	0.8 mm	Shielded	Chrome Steel	Chrome Steel	48 X 1000 rpm
MF85	5 mm	8 mm	2 mm	9.2 mm	0.6 mm	Open	Chrome Steel	Chrome Steel	53 X 1000 rpm
MF85 2rs	5 mm	8 mm	2.5 mm	9.2 mm	0.6 mm	Sealed	Chrome Steel	Chrome Steel	53 X 1000 rpm
MF85zz	5 mm	8 mm	2.5 mm	9.2 mm	0.6 mm	Shielded	Chrome Steel	Chrome Steel	53 X 1000 rpm
MF95	5 mm	9 mm	2.5 mm	10.2 mm	0.6 mm	Open	Chrome Steel	Chrome Steel	50 X 1000 rpm
MF95 2rs	5 mm	9 mm	3 mm	10.2 mm	0.6 mm	Sealed	Chrome Steel	Chrome Steel	50 X 1000 rpm
MF95zz	5 mm	9 mm	3 mm	10.2 mm	0.6 mm	Shielded	Chrome Steel	Chrome Steel	50 X 1000 rpm
MF105	5 mm	10 mm	3 mm	11.2 mm	0.6 mm	Open	Chrome Steel	Chrome Steel	50 X 1000 rpm
MF105 2rs	5 mm	10 mm	4 mm	11.6 mm	0.8 mm	Sealed	Chrome Steel	Chrome Steel	50 X 1000 rpm
MF105zz	5 mm	10 mm	4 mm	11.6 mm	0.8 mm	Shielded	Chrome Steel	Chrome Steel	50 X 1000 rpm
MF115	5 mm	11 mm	4 mm	12.6 mm	0.8 mm	Open	Chrome Steel	Chrome Steel	45 X 1000 rpm
MF115 2rs	5 mm	11 mm	4 mm	12.6 mm	0.8 mm	Sealed	Chrome Steel	Chrome Steel	45 X 1000 rpm
MF115zz	5 mm	11 mm	4 mm	12.6 mm	0.8 mm	Shielded	Chrome Steel	Chrome Steel	45 X 1000 rpm
MF106	6 mm	10 mm	2.5 mm	11.2 mm	0.6 mm	Open	Chrome Steel	Chrome Steel	45 X 1000 rpm
MF106 2rs	6 mm	10 mm	3 mm	11.2 mm	0.6 mm	Sealed	Chrome Steel	Chrome Steel	45 X 1000 rpm
MF106zz	6 mm	10 mm	3 mm	11.2 mm	0.6 mm	Shielded	Chrome Steel	Chrome Steel	45 X 1000 rpm
MF126	6 mm	12 mm	3 mm	13.2 mm	0.6 mm	Open	Chrome Steel	Chrome Steel	43 X 1000 rpm
MF126 2rs	6 mm	12 mm	4 mm	13.6 mm	0.8 mm	Sealed	Chrome Steel	Chrome Steel	43 X 1000 rpm
MF126zz	6 mm	12 mm	4 mm	13.6 mm	0.8 mm	Shielded	Chrome Steel	Chrome Steel	43 X 1000 rpm
MF117	7 mm	11 mm	2.5 mm	12.2 mm	0.6 mm	Open	Chrome Steel	Chrome Steel	43 X 1000 rpm
MF117 2rs	7 mm	11 mm	3 mm	12.2 mm	0.6 mm	Sealed	Chrome Steel	Chrome Steel	43 X 1000 rpm
MF117zz	7 mm	11 mm	3 mm	12.2 mm	0.6 mm	Shielded	Chrome Steel	Chrome Steel	43 X 1000 rpm
MF137	7 mm	13 mm	3 mm	14.2 mm	0.6 mm	Open	Chrome Steel	Chrome Steel	40 X 1000 rpm
MF137 2rs	7 mm	13 mm	4 mm	14.6 mm	0.8 mm	Sealed	Chrome Steel	Chrome Steel	40 X 1000 rpm



MF Series Flanged Miniature Bearings

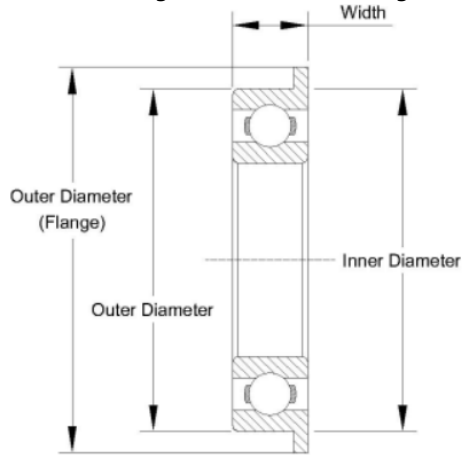

Part Number	Bore diameter	Outside diameter	Width	Flange outer diameter	Flange thickness	Seal type	Ring material	Ball material	Limiting speed
MF137zz	7 mm	13 mm	4 mm	14.6 mm	0.8 mm	Shielded	Chrome Steel	Chrome Steel	40 X 1000 rpm
MF128	8 mm	12 mm	2.5 mm	13.2 mm	0.6 mm	Open	Chrome Steel	Chrome Steel	40 X 1000 rpm
MF128 2rs	8 mm	12 mm	3.5 mm	13.6 mm	0.8 mm	Sealed	Chrome Steel	Chrome Steel	40 X 1000 rpm
MF128zz	8 mm	12 mm	3.5 mm	13.6 mm	0.8 mm	Shielded	Chrome Steel	Chrome Steel	40 X 1000 rpm
MF148	8 mm	14 mm	3.5 mm	15.6 mm	0.8 mm	Open	Chrome Steel	Chrome Steel	38 X 1000 rpm
MF148 2rs	8 mm	14 mm	4 mm	15.6 mm	0.8 mm	Sealed	Chrome Steel	Chrome Steel	38 X 1000 rpm
MF148zz	8 mm	14 mm	4 mm	15.6 mm	0.8 mm	Shielded	Chrome Steel	Chrome Steel	38 X 1000 rpm